

TERMINALS OF ECU

1. CHECK MAIN BODY ECU

Main Body ECU:

Left View:

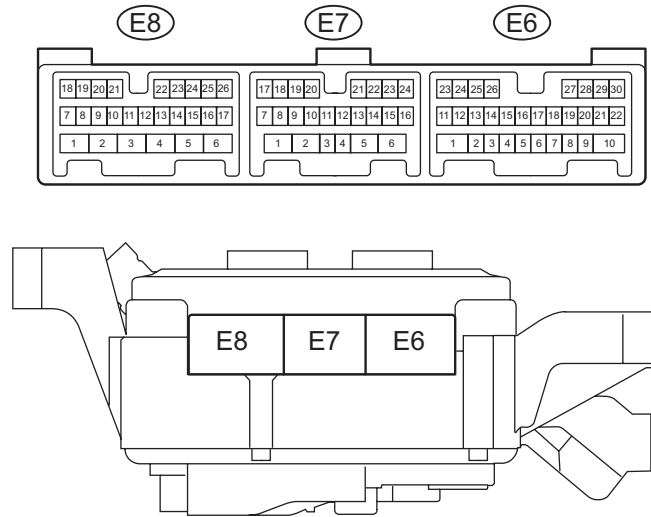

Rear View:

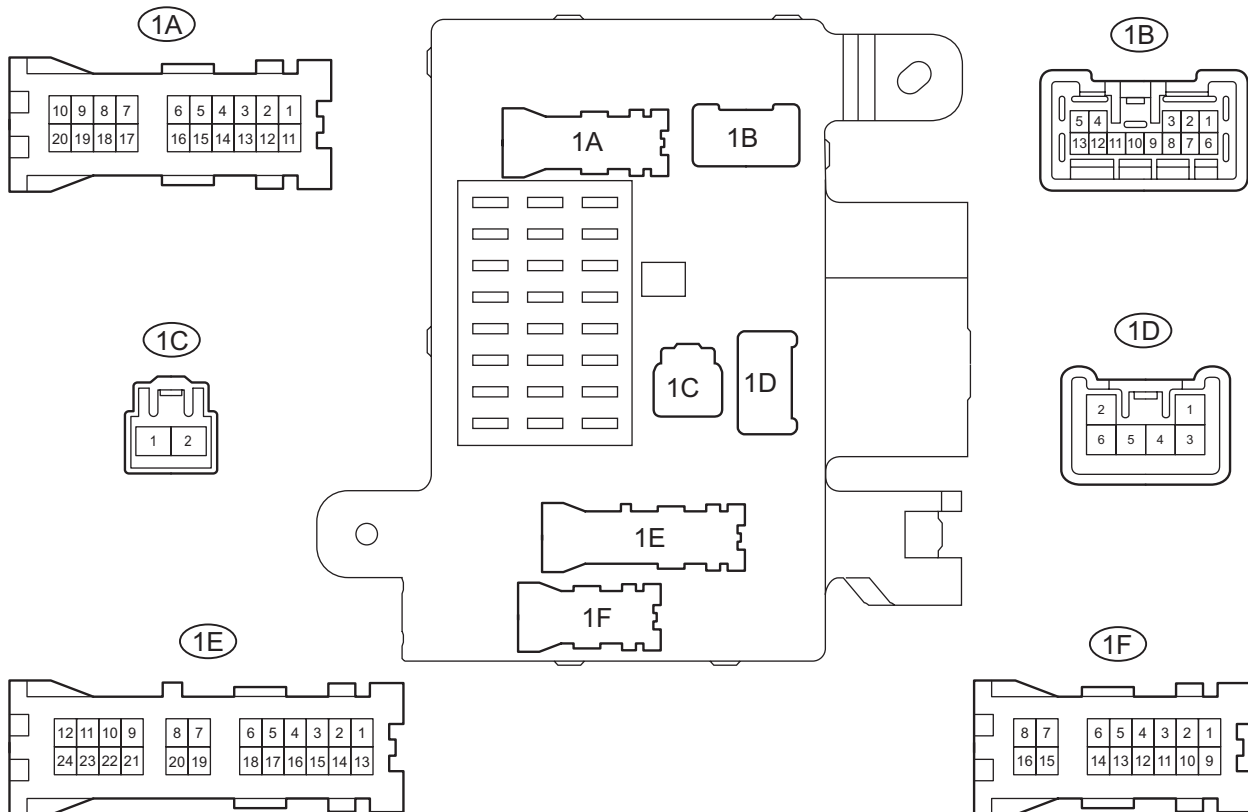

Main Body ECU:

Front View:

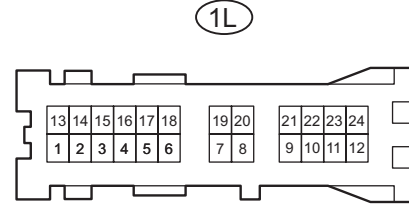
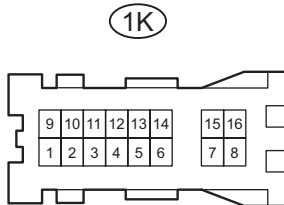
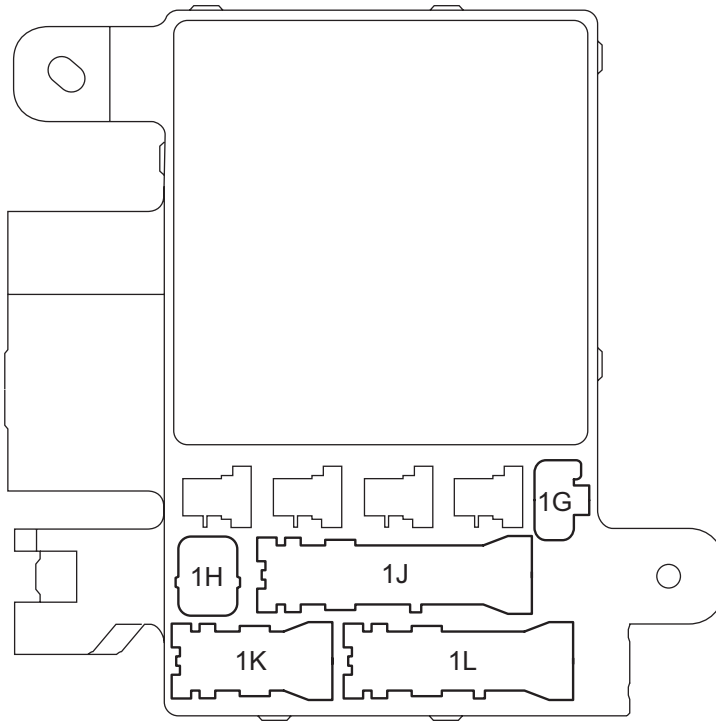
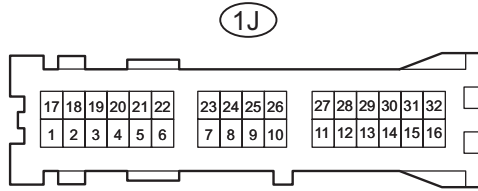
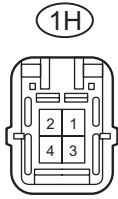

Y

B136052E01

(a) Disconnect the 1A, 1B, 1E, and 1H main body ECU (driver side J/B) connectors.

- (b) Measure the voltages and resistances of the wire harness side connectors.

Standard:

Symbols (Terminal No.)	Wiring Color	Terminal Description	Condition	Specified Condition
GND1 (1H-2) - Body ground	W-B - Body ground	Ground	Always	Below 1 Ω
BECU (1B-4) - Body ground	W-R - Body ground	Power source circuit (From battery)	Always	11 to 14 V
BDR1 (1E-9) - Body ground	B-Y - Body ground	Power source circuit (From battery)	Always	11 to 14 V
GND2 (1A-7) - Body ground	W - Body ground	Ground	Always	Below 1 Ω

If the result is not as specified, there may be a malfunction in the wire harness.

- (c) Reconnect the main body ECU (driver side J/B) connectors.
 (d) Measure the voltages of the wire harness side connectors.

Standard voltage:

Symbols (Terminal No.)	Wiring Color	Terminal Description	Condition	Specified Condition
SIG - (1F-8) Body ground	B-R - Body ground	Ignition switch signal	Ignition switch OFF	Below 1 V
			Ignition switch ON	10 to 14 V
ILE (1A-8) - Body ground	W - Body ground	Illumination signal (To room light assembly)	Driver door closed	10 to 14 V
			Driver door open	Below 1 V
HRLY (1B-8) - Body ground	Y-P - Body ground	HEAD signal (To HEAD relay)	Light control switch OFF or in TAIL	10 to 14 V
			Light control switch in HEAD	Below 1 V
TRLY (1E-16) - Body ground	V - Body ground	TAIL signal (To TAIL relay)	Light control switch OFF	10 to 14 V
			Light control switch in TAIL or HEAD	Below 1 V
ACC (1D-5) - Body ground	W-G - Body ground	Ignition switch (From battery) ACC signal circuit (To ignition switch)	Ignition switch OFF	Below 1 V
			Ignition switch ACC	10 to 14 V
H-ON (1B-3)* - Body ground	GR-G* - Body ground	DRL signal (To DRL relay)	Light control switch OFF or in TAIL position and engine running and parking brake off	Below 1 V
			Ignition switch OFF	10 to 14 V
LMRY (E6-3) - Body ground	GR-R - Body ground	DOME relay output signal (To DOME relay)	All doors locked	10 to 14 V
			Any door open	Below 1 V
DIM* (E6-7) - Body ground	R-G* - Body ground	DIM relay output signal (To DIM relay)	Dimmer switch in FLASH or HIGH	Below 1 V
			Dimmer switch in LOW	10 to 14 V
L* (E6-14) - Body ground	GR* - Body ground	Generator operate condition signal	Engine start Charge warning light ON	Below 1 V
			Engine start Charge warning light OFF	10 to 14 V
PKB* (E7-2) - Body ground	W-R* - Body ground	Parking brake switch signal	Parking brake switch ON	Below 1 V
			Parking brake switch OFF	10 to 14 V
BCTY (E7-7) - Body ground	W - Body ground	Back door courtesy switch and back window courtesy switch input	Back door or back window open	Below 1 V
			Back door and back window closed	11 to 14 V
RLCY (E7-11) - Body ground	P-B - Body ground	Rear LH door courtesy switch input	Rear LH door open	Below 1 V
			Rear LH door closed	11 to 14 V

Symbols (Terminal No.)	Wiring Color	Terminal Description	Condition	Specified Condition
RRCY (E7-12) - Body ground	P-L - Body ground	Rear RH door courtesy switch input	Rear RH door open	Below 1 V
			Rear RH door closed	11 to 14 V
DCTY (E7-23) - Body ground	R-B - Body ground	Driver door courtesy switch input	Driver door open	Below 1 V
			Driver door closed	11 to 14 V
PCTY (E7-24) - Body ground	G-Y - Body ground	Front passenger door courtesy switch input	Front passenger door open	Below 1 V
			Front passenger door closed	11 to 14 V
HEAD (E8-1) - Body ground	R - Body ground	Light control switch (HEAD signal)	Light control switch OFF	11 to 14 V
			Light control switch is ON	Below 1 V
HU* (E8-2) - Body ground	R-G* - Body ground	Headlight dimmer switch (HIGH signal)	Headlight dimmer switch in HIGH	Below 1 V
			Headlight dimmer switch in LOW	11 to 14 V
HF (E8-7) - Body ground	R-W - Body ground	Headlight dimmer switch (FLASH signal)	Headlight dimmer switch in FLASH	Below 1 V
			Headlight dimmer switch in LOW or HIGH	11 to 14 V
TAIL (E8-8) - Body ground	G - Body ground	Light control switch (TAIL signal)	Light control switch in TAIL	Below 1 V
			Light control switch OFF	11 to 14 V
DRLP (E8-12) - Body ground	V-Y - Body ground	Open door warning light output	Open door warning light ON	Below 1.2 V
			Open door warning light OFF	10 to 14 V
HF2 (E8-20) - Body ground	Y-P - Body ground	Headlight dimmer switch (FLASH signal)	Headlight dimmer switch in FLASH	Below 1 V
			Headlight dimmer switch in LOW or HIGH	10 to 14 V

HINT:

*: w/ daytime running light system

If the result is not as specified, there may be a malfunction in the wire harness.

